

- Legend:**
- City Boundary
 - Proposed Development boundary
 - Proposed Road Development
 - Proposed Culvert (C)
 - Proposed Attenuation Pond / Infiltration Basin
 - Proposed Stream Diversion
 - Drainage Network Sections
 - S00 Catchment Reference Section
 - Drainage Outfall

San áiríúmh tá sonraíocht Shuirbhíreacht Orlándaís Éireann arna aistriúgeadh fíú Cheadúnas OSI Uimh. 2010/18CCMA/Comhairle Contae na Gaillimhe. Sárúimh aistriúgeadh neamhdáraithe cóipeacht Shuirbhíreacht Orlándaís Éireann agus Rialtas na hÉireann. © Suirbhíreacht Orlándaís Éireann, 2010.

Includes Ordnance Survey Ireland data reproduced under OSI Licence number 2010/18CCMA/Galway County Council. Unauthorised reproduction infringes Ordnance Survey Ireland and Government of Ireland copyright. © Ordnance Survey Ireland, 2010.

© Ordnance Survey Ireland. All rights reserved. Licence number 2010/18CCMA/Galway County Council.

Clients

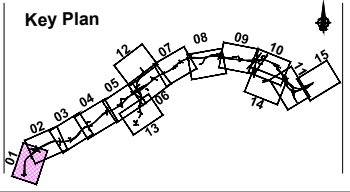

Consultant

Corporate House
City East Business Park
Ballybrit, Galway, Ireland.

Tel +353 (0)91 460675
www.N6GalwayCity.ie
www.arup.ie

Job Title
N6 Galway City Ring Road

Scale
1:5000 @ A3

Date:
September 2018

Issue	Date	By	Chkd	Appd
11	28/09/2018	KJ	MH	EMC

Drawing Title
Proposed Road Development Plan Layout and Drainage Network
Sheet 1 of 15

Drawing Status
For Information

Job No
233985

Drawing No
Figure 11.5.101

Issue
11

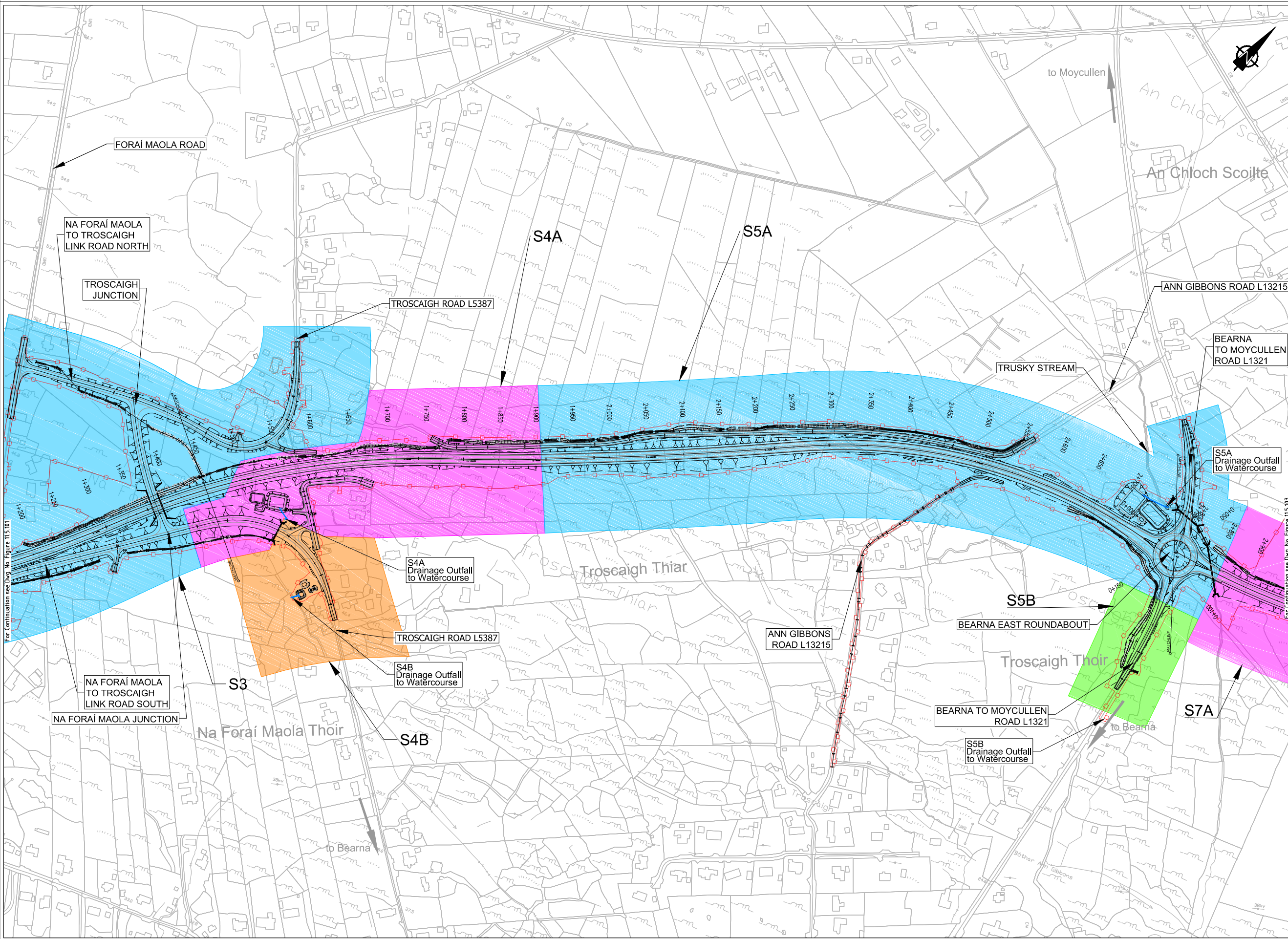

- Legend:**
- City Boundary
 - - - Proposed Development boundary
 - ▬▬▬ Proposed Road Development
 - Proposed Culvert (C)
 - ▭ Proposed Attenuation Pond / Infiltration Basin
 - ~ Proposed Stream Diversion
 - █ Drainage Network Sections
 - ↖ S00 Catchment Reference Section
 - ▭ Drainage Outfall

For continuation see Fig. No. Figure 11.5.101

For continuation see Fig. No. Figure 11.5.103

Son áiríonn sé sonraíocht Shuirbhíreacht Orlándaí Éireann arna aistriú go dtí fíor Chéadainn OSI Umh. 2010/18CCMA/Comhairle Contae na Gaillimhe. Sáráilonn aistriú go dtí na neamháráilte cíoscheart Shuirbhíreacht Orlándaí Éireann agus Rialtas na hÉireann. © Suirbhíreacht Orlándaí Éireann, 2010.

© Suirbhíreacht Orlándaí Éireann. Gach ceart ar chosaint. Umhír cheadainn 2010/18CCMA/Comhairle Contae na Gaillimhe.

Includes Ordnance Survey Ireland data reproduced under OSI Licence number 2010/18CCMA/Galway County Council. Unauthorised reproduction infringes Ordnance Survey Ireland and Government of Ireland copyright. © Ordnance Survey Ireland, 2010.

© Ordnance Survey Ireland. All rights reserved. Licence number 2010/18CCMA/Galway County Council.

Clients

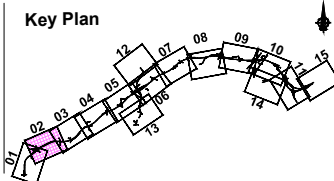

Consultant

Corporate House
City East Business Park
Ballybrit, Galway, Ireland.

Tel +353 (0)91 460675
www.N6GalwayCity.ie
www.arup.ie

Job Title
N6 Galway City Ring Road

Scale
1:5000 @ A3

Date:
September 2018

Issue	Date	By	Chkd	Appd
11	28/09/2018	KJ	MH	EMC

Drawing Title
Proposed Road Development Plan Layout and Drainage Network
Sheet 2 of 15

Drawing Status
For Information

Job No
233985

Drawing No
Figure 11.5.102

Issue
11

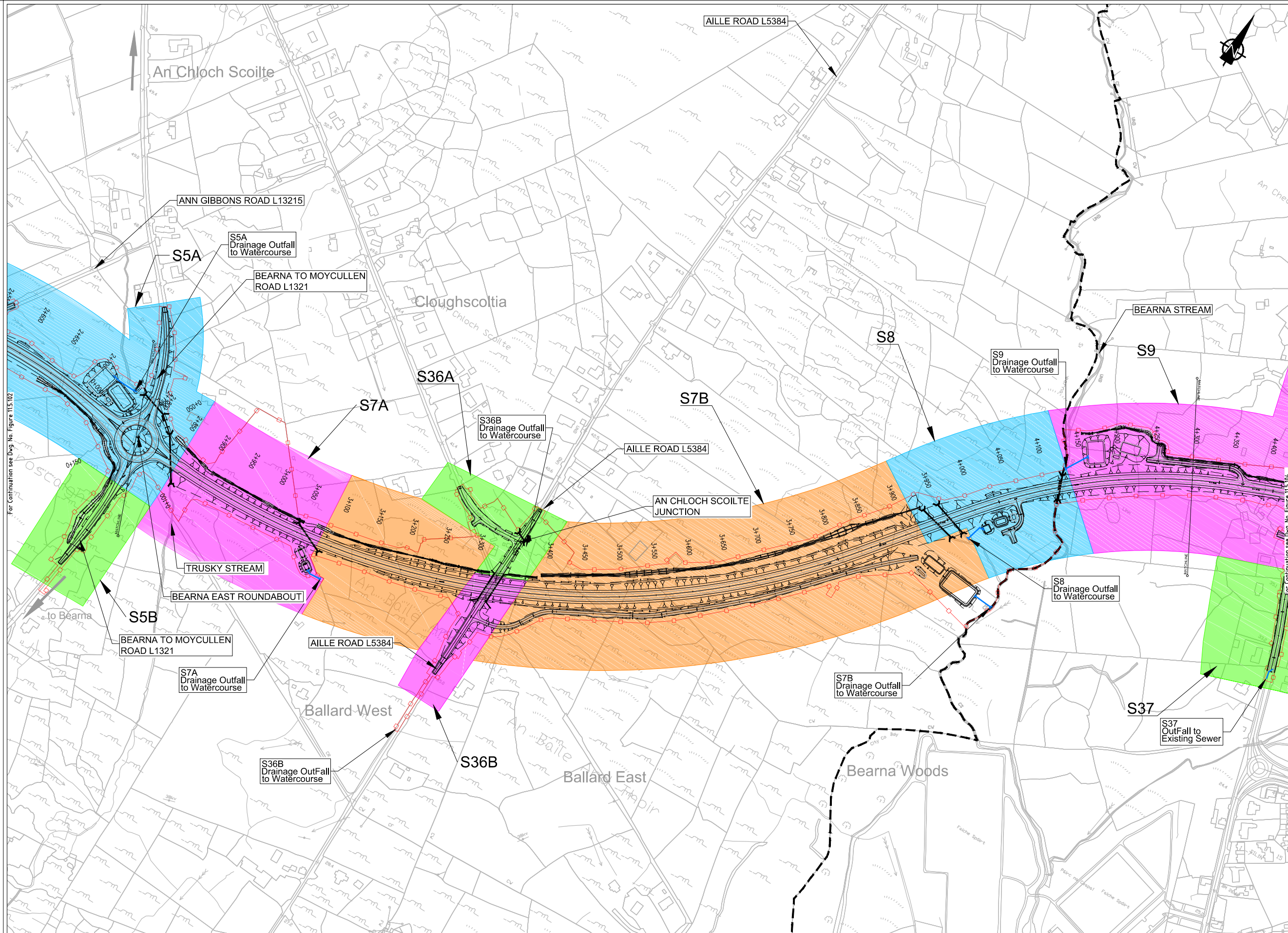

- Legend:**
- City Boundary
 - Proposed Development boundary
 - Proposed Road Development
 - Proposed Culvert (C)
 - Proposed Attenuation Pond / Infiltration Basin
 - Proposed Stream Diversion
 - Drainage Network Sections
 - S00 Catchment Reference Section
 - Drainage Outfall

For Continuation see Fig. No. Figure 11.5.102

For Continuation see Fig. No. Figure 11.5.104

Son áiríamh tá sonraíocht Shuirbhíreacht Orlándaí Éireann arna aistriú go dtí físeán OSI Uimh. 2010/18CCMA/Comhairle Contae na Gaillimhe. Sáráilom aistriú go dtí na meáin eile. © Suirbhíreacht Orlándaí Éireann, 2010.

© Suirbhíreacht Orlándaí Éireann. Gach ceart ar chosaint. Uimhir cheadainn 2010/18CCMA/Comhairle Contae na Gaillimhe.

Includes Ordnance Survey Ireland data reproduced under OSI Licence number 2010/18CCMA/Galway County Council. Unauthorised reproduction infringes Ordnance Survey Ireland and Government of Ireland copyright. © Ordnance Survey Ireland, 2010.

© Ordnance Survey Ireland. All rights reserved. Licence number 2010/18CCMA/Galway County Council.

Clients

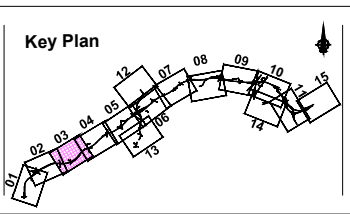

Consultant

Corporate House
City East Business Park
Ballybrit, Galway, Ireland.

Tel +353 (0)91 460675
www.N6GalwayCity.ie
www.arup.ie

Job Title
N6 Galway City Ring Road

Scale
1:5000 @ A3

Date:
September 2018

Issue	Date	By	Chkd	Appd
11	28/09/2018	KJ	MH	EMC

Drawing Title
Proposed Road Development Plan Layout and Drainage Network
Sheet 3 of 15

Drawing Status
For Information

Job No
233985

Drawing No
Figure 11.5.103

Issue
11

- Legend:**
- City Boundary
 - - - Proposed Development boundary
 - ▬▬▬ Proposed Road Development
 - |—|—| Proposed Culvert (C)
 - ▭ Proposed Attenuation Pond / Infiltration Basin
 - ~ Proposed Stream Diversion
 - █ Drainage Network Sections
 - ↖ S00 Catchment Reference Section
 - ▭ Drainage Outfall

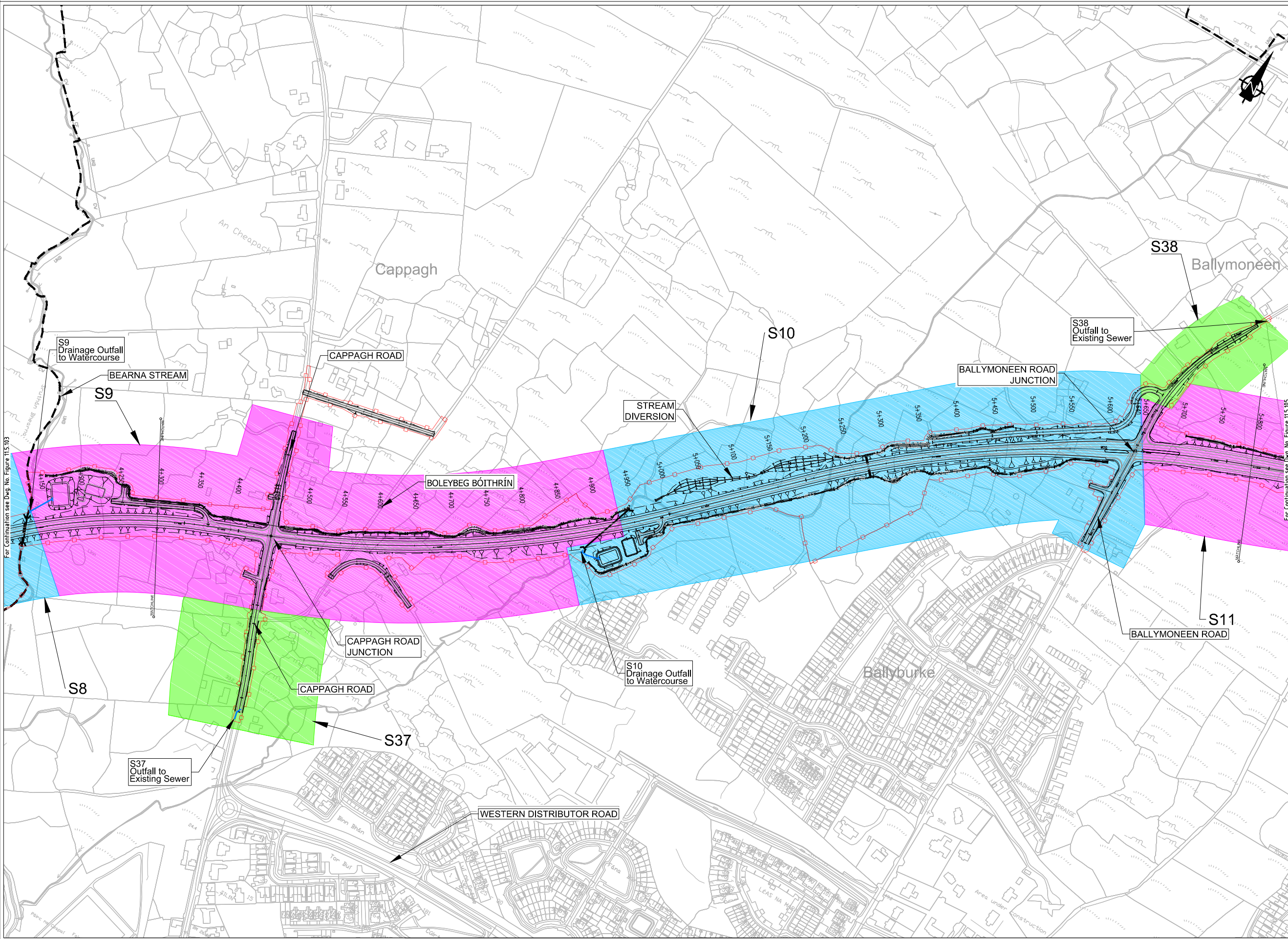

Son áiríonn sé na sonraíochtaí Shuirbhíreacht Orlándaí Éireann arna aistriú go dtí físeán Chaidéas OSI Uimh. 2010/18CCMA/Comhairle Contae na Gaillimhe. Sáráilonn aistriú go dtí neamháráil na cíoscheart Shuirbhíreacht Orlándaí Éireann agus Rialtas na hÉireann. © Suirbhíreacht Orlándaí Éireann, 2010.

© Suirbhíreacht Orlándaí Éireann. Gach ceart ar chosaint. Uimhir cheadúnais 2010/18CCMA/Comhairle Contae na Gaillimhe.

Includes Ordnance Survey Ireland data reproduced under OSI Licence number 2010/18CCMA/Galway County Council. Unauthorised reproduction infringes Ordnance Survey Ireland and Government of Ireland copyright. © Ordnance Survey Ireland, 2010.

© Ordnance Survey Ireland. All rights reserved. Licence number 2010/18CCMA/Galway County Council.

Clients

Comhairle Contae na Gaillimhe
Galway County Council

Galway City Transport Project

An Roinn Iompair
Turasóireachta agus Spóirt
Department of Transport, Tourism and Sport

TIIP
Bonnasair Iompair Éireann
Transport Infrastructure Ireland

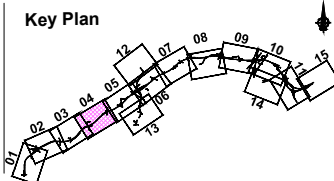

Consultant

ARUP

Corporate House
City East Business Park
Ballybrit, Galway, Ireland.

Tel +353 (0)91 460675
www.N6GalwayCity.ie
www.arup.ie

Job Title
N6 Galway City Ring Road

Scale
1:5000 @ A3

Date:
September 2018

Issue	Date	By	Chkd	Appd
11	28/09/2018	KJ	MH	EMC

Drawing Title
Proposed Road Development Plan Layout and Drainage Network
Sheet 4 of 15

Drawing Status
For Information

Job No
233985

Drawing No
Figure 11.5.104

Issue
11

- Legend:**
- City Boundary
 - Proposed Development boundary
 - Proposed Road Development
 - Proposed Culvert (C)
 - Proposed Attenuation Pond / Infiltration Basin
 - Proposed Stream Diversion
 - Drainage Network Sections
 - S00 Catchment Reference Section
 - Drainage Outfall

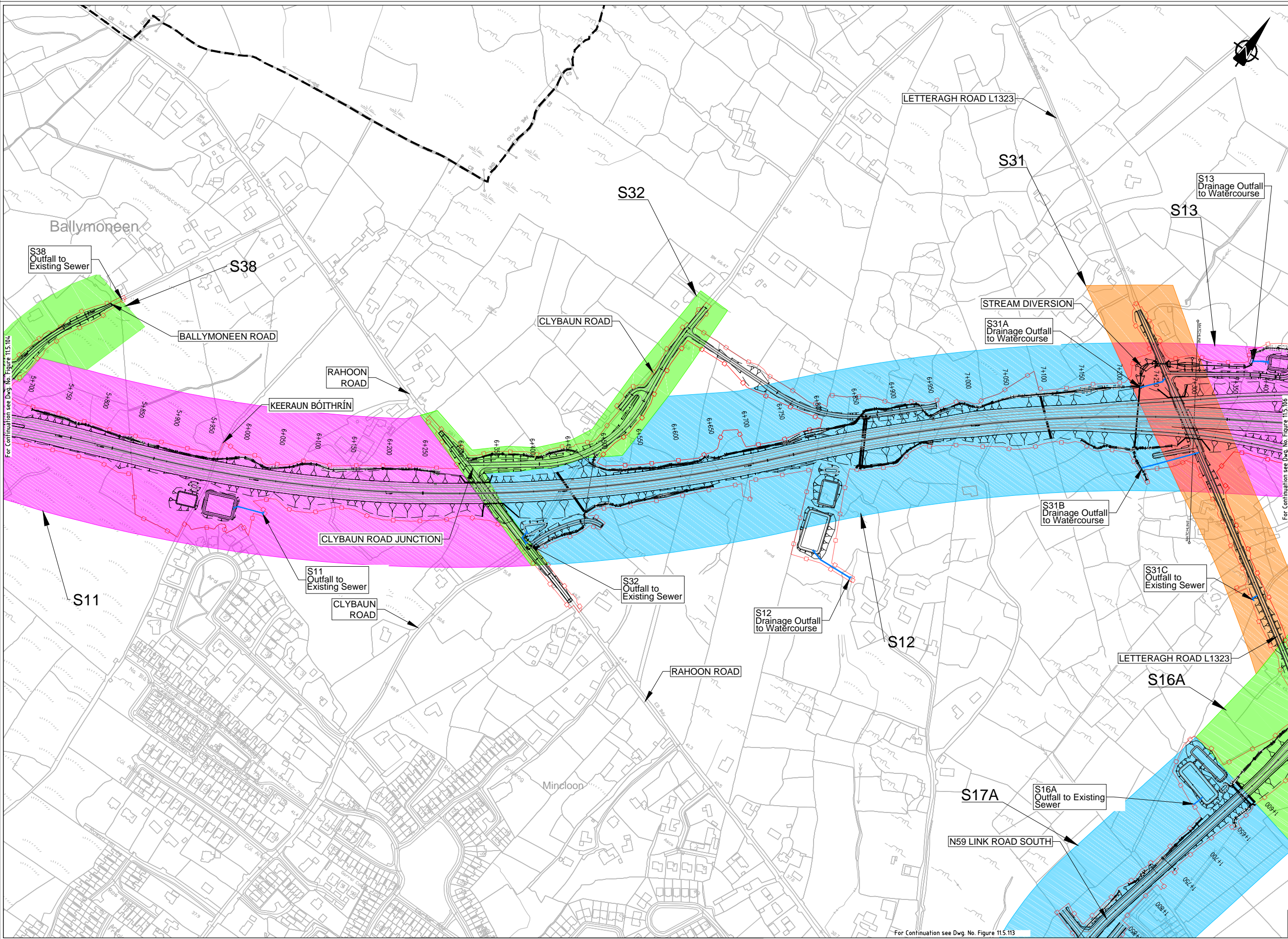

San áiríúmh tá sonraíocht Shuirbhéiríocht Orlándaí Éireann arís áiríúmh fíúí Cheadúnas OSI Uimh. 2010/18CCMA/Comhairle Contae na Gaillimhe. Sáráilom áiríúmh neamhádaraithe cóipeacht Shuirbhéiríocht Orlándaí Éireann agus Rialtas na hÉireann. © Suirbhéiríocht Orlándaí Éireann, 2010.

© Suirbhéiríocht Orlándaí Éireann. Gach ceart ar chosaint. Uimhíir cheadúnas 2010/18CCMA/Comhairle Contae na Gaillimhe.

Includes Ordnance Survey Ireland data reproduced under OSI Licence number 2010/18CCMA/Galway County Council. Unauthorised reproduction infringes Ordnance Survey Ireland and Government of Ireland copyright. © Ordnance Survey Ireland, 2010.

© Ordnance Survey Ireland. All rights reserved. Licence number 2010/18CCMA/Galway County Council.

Clients

Comhairle Contae na Gaillimhe
Galway County Council

N6 Galway City Transport Project

An Roinn Iompair
Turasóireachta agus Spóirt

TIIP
Bonnáiríocht Turasóireachta agus Spóirt

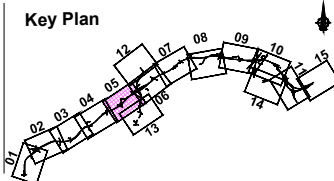

Consultant

ARUP

Corporate House
City East Business Park
Ballybrit, Galway, Ireland.

Tel +353 (0)91 460675
www.N6GalwayCity.ie
www.arup.ie

Job Title
N6 Galway City Ring Road

Scale
1:5000 @ A3

Date:
September 2018

Issue	Date	By	Chkd	Appd
11	28/09/2018	KJ	MH	EMC

Drawing Title
Proposed Road Development Plan Layout

Sheet 5 of 15

Drawing Status
For Information

Job No
233985

Drawing No
Figure 11.5.105

Issue
11

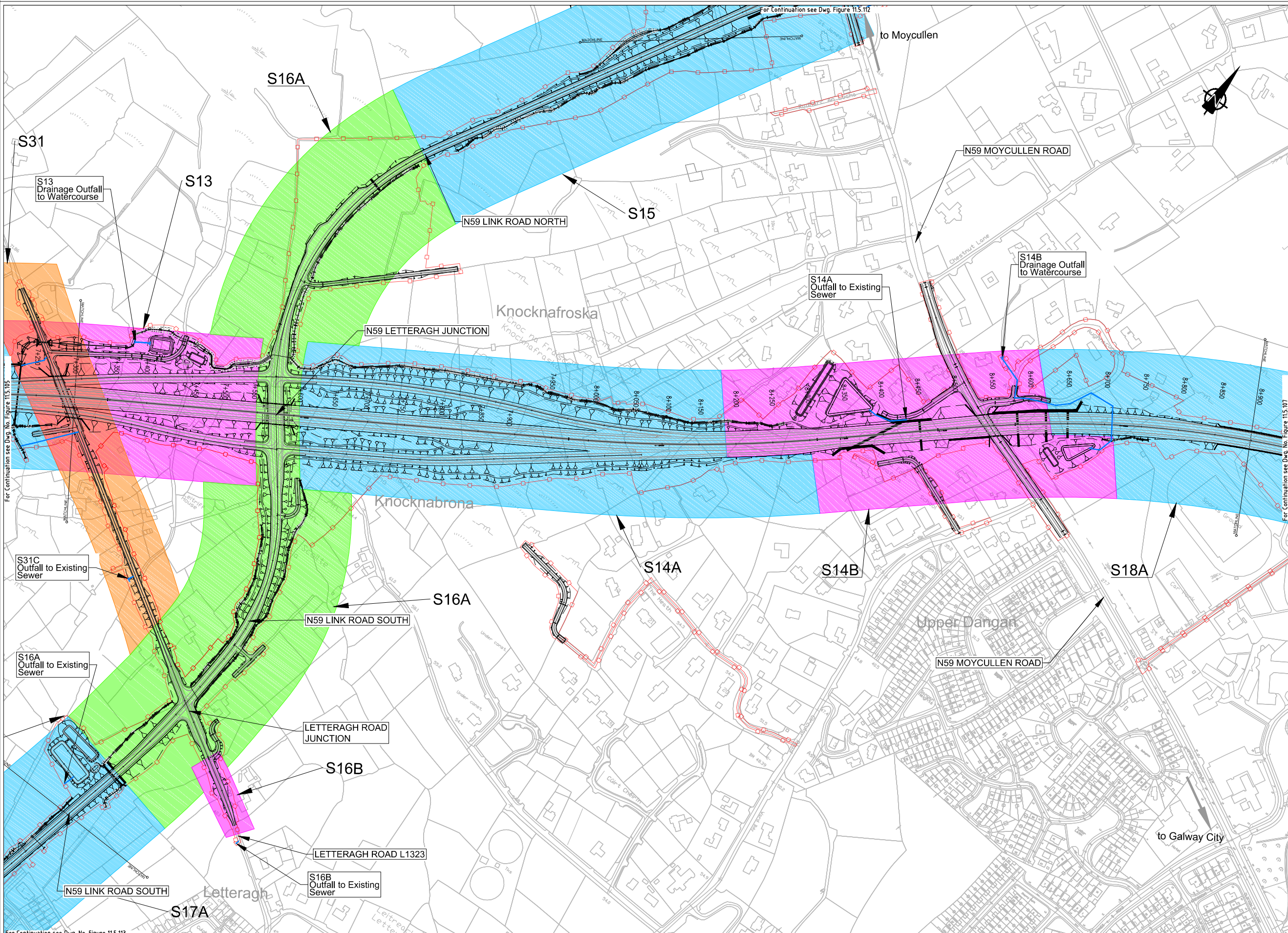

- Legend:**
- City Boundary
 - - - Proposed Development boundary
 - ▬▬▬ Proposed Road Development
 - (C)— Proposed Culvert (C)
 - ▭ Proposed Attenuation Pond / Infiltration Basin
 - ~ Proposed Stream Diversion
 - █ Drainage Network Sections
 - ↖ S00 Catchment Reference Section
 - ▭ Drainage Outfall

For Continuation see Dwg. No. Figure 11.5.105

For Continuation see Dwg. No. Figure 11.5.107

San áiríúmh tá sonraíocht Shuirbhíreachtú Ordnáis Éireann arna aistriú go dtí físeánúis OSI Uimh. 2010/18CCMA/Comhairle Contae na Gaillimhe. Sáráilom aistriú go dtí neamhádarthaí cóscheart Shuirbhíreachtú Ordnáis Éireann agus Rialtas na hÉireann. © Suirbhíreachtú Ordnáis Éireann, 2010.

© Suirbhíreachtú Ordnáis Éireann. Gach ceart ar chosaint. Uimhir cheadainis 2010/18CCMA/Comhairle Contae na Gaillimhe.

Includes Ordnance Survey Ireland data reproduced under OSI Licence number 2010/18CCMA/Galway County Council. Unauthorised reproduction infringes Ordnance Survey Ireland and Government of Ireland copyright. © Ordnance Survey Ireland, 2010.

© Ordnance Survey Ireland. All rights reserved. Licence number 2010/18CCMA/Galway County Council.

Clients

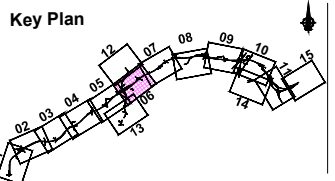

Consultant

Corporate House
City East Business Park
Ballybrit, Galway, Ireland.

Tel +353 (0)91 460675
www.N6GalwayCity.ie
www.arup.ie

Job Title
N6 Galway City Ring Road and Drainage Network

Scale
1:5000 @ A3

Date
September 2018

Issue	Date	By	Chkd	Appd
11	28/09/2018	KJ	MH	EMC

Drawing Title
Proposed Road Development Plan Layout and Drainage Network

Sheet 6 of 15

Drawing Status
For Information

Job No
233985

Drawing No
Figure 11.5.106

Issue
11

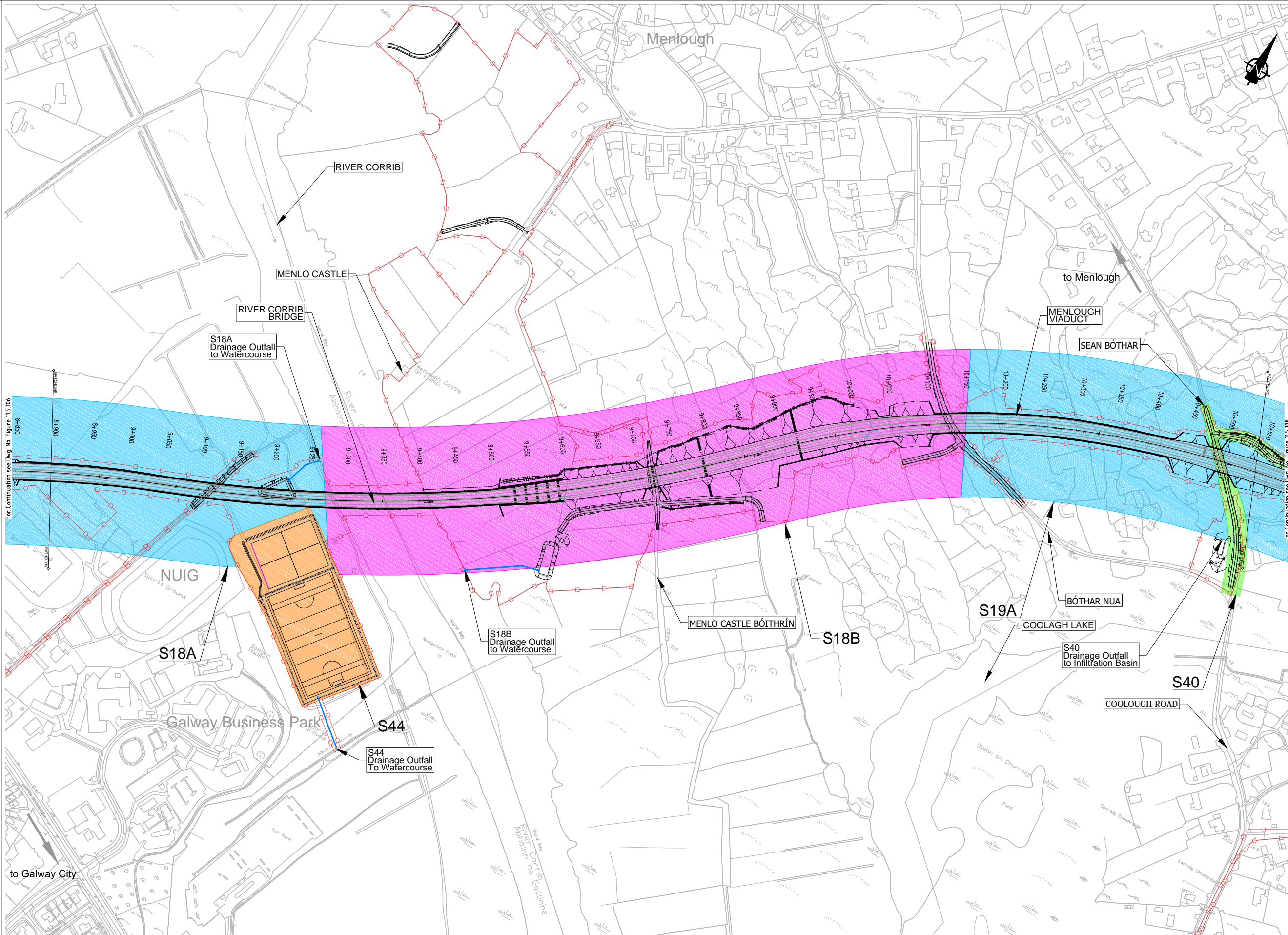

- Legend:**
- City Boundary
 - Proposed Development boundary
 - ▬▬▬ Proposed Road Development
 - Proposed Culvert (C)
 - ▭ Proposed Attenuation Pond / Infiltration Basin
 - ~ Proposed Stream Diversion
 - █ Drainage Network Sections
 - ↖ S00 Catchment Reference Section
 - ▭ Drainage Outfall

For Continuation see Dwg. No. Figure 11.5.106

For Continuation see Dwg. No. Figure 11.5.108

Son áiríomh tá sonraíocht Shairbhéireacht Orlándaí Éireann arna aistriú ganúlacht fíor Cheadúnas OSI Uimh. 2010/18CCMA/Comhairle Contae na Gaillimhe. Sárúilom aistriú ganúlacht na mbhídaraithe cóipeacht Shairbhéireacht Orlándaí Éireann agus Rialtas na hÉireann. © Sairbhéireacht Orlándaí Éireann, 2010.

© Sairbhéireacht Orlándaí Éireann. Gach ceart ar chosaint. Uimhir cheadúnais 2010/18CCMA/Comhairle Contae na Gaillimhe.

Includes Ordnance Survey Ireland data reproduced under OSI Licence number 2010/18CCMA/Galway County Council. Unauthorised reproduction infringes Ordnance Survey Ireland and Government of Ireland copyright. © Ordnance Survey Ireland, 2010.

© Ordnance Survey Ireland. All rights reserved. Licence number 2010/18CCMA/Galway County Council.

Clients

Comhairle Chontae na Gaillimhe
Galway County Council

Galway City Transport Project

An Roinn Iompair
Turasóireachta agus Spóirt
Department of Transport, Tourism and Sport

TIIP
Transport Infrastructure Ireland

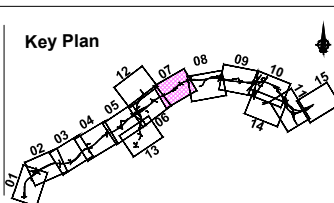

Consultant

ARUP

Corporate House
City East Business Park
Ballybrit, Galway, Ireland.

Tel +353 (0)91 460675
www.N6GalwayCity.ie
www.arup.ie

Job Title
N6 Galway City Ring Road

Scale
1:5000 @ A3

Date:
September 2018

Issue	Date	By	Chkd	Appd
11	28/09/2018	KJ	MH	EMC

Drawing Title
Proposed Road Development Plan Layout and Drainage Network
Sheet 7 of 15

Drawing Status
For Information

Job No
233985

Drawing No
Figure 11.5.107

Issue
11

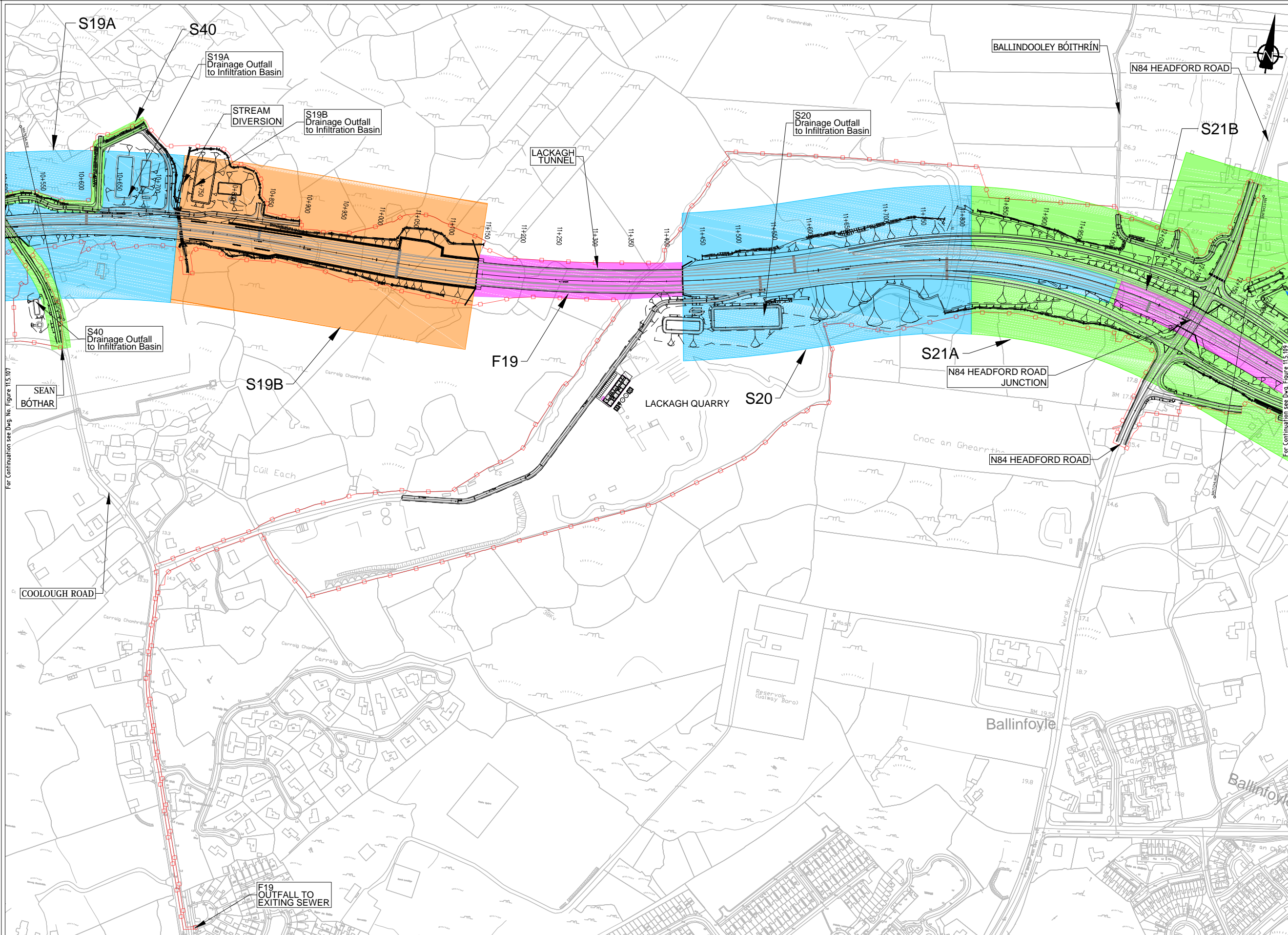

- Legend:**
- City Boundary
 - - - Proposed Development boundary
 - ▬▬▬ Proposed Road Development
 - C— Proposed Culvert (C)
 - ▭▭▭ Proposed Attenuation Pond / Infiltration Basin
 - D— Proposed Stream Diversion
 - █ Drainage Network Sections
 - 0— S00 Catchment Reference Section
 - 0— Drainage Outfall

For Continuation see Dwg No. Figure 11.5.107

For Continuation see Dwg. Figure 11.5.109

Son áiríomh tá sonraíocht Shairbhíreacht Orlándaís Éireann arna aistriúgeadh fíor Cheadúnas OSI Uimh. 2010/18CCMA/Comhairle Contae na Gaillimhe. Sáráilom aistriúgeadh neamhdáraithe cóipeacht Shairbhíreacht Orlándaís Éireann agus Rialtas na hÉireann. © Sairbhíreacht Orlándaís Éireann, 2010.

© Sairbhíreacht Orlándaís Éireann. Gach ceart ar chosaint. Uimhir cheadúnais 2010/18CCMA/Comhairle Contae na Gaillimhe.

Includes Ordnance Survey Ireland data reproduced under OSI Licence number 2010/18CCMA/Galway County Council. Unauthorised reproduction infringes Ordnance Survey Ireland and Government of Ireland copyright. © Ordnance Survey Ireland, 2010.

© Ordnance Survey Ireland. All rights reserved. Licence number 2010/18CCMA/Galway County Council.

Clients

Comhairle Chontae na Gaillimhe
Galway County Council

Galway City Transport Project

An Roinn Iompair
Turasóireacht agus Spóirt
Department of Transport, Tourism and Sport

TII
Transport Infrastructure Ireland

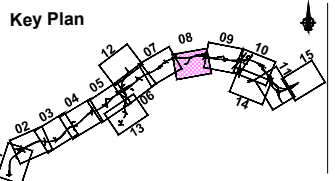

Consultant

ARUP

Corporate House
City East Business Park
Ballybrit, Galway, Ireland.

Tel +353 (0)91 460675
www.N6GalwayCity.ie
www.arup.ie

Job Title
N6 Galway City Ring Road

Scale
1:5000 @ A3

Date:
September 2018

Issue	Date	By	Chkd	Appd
11	28/09/2018	KJ	MH	EMC

Drawing Title
Proposed Road Development Plan Layout and Drainage Network
Sheet 8 of 15

Drawing Status
For Information

Job No
233985

Drawing No
Figure 11.5.108

Issue
11

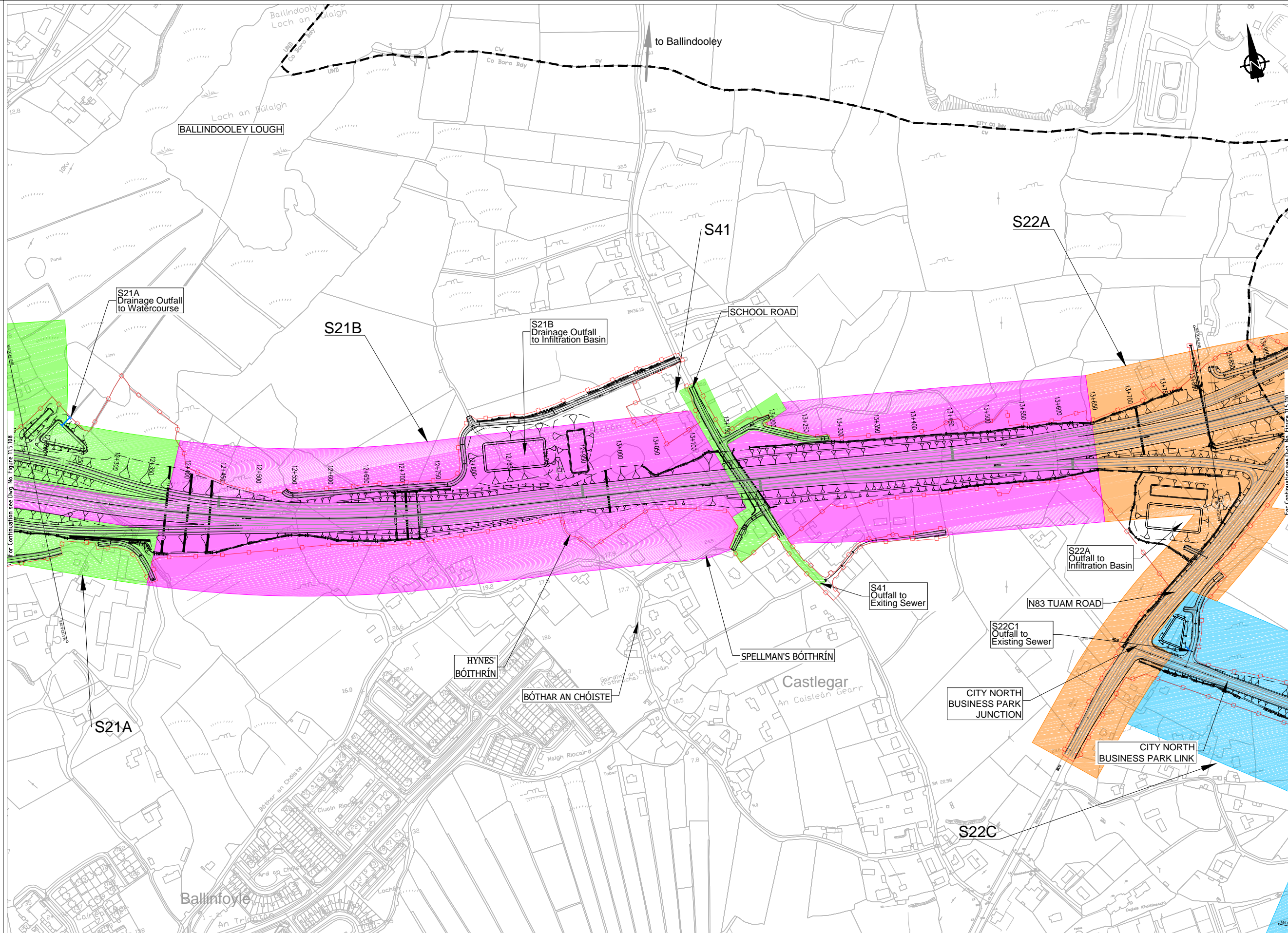

- Legend:**
- City Boundary
 - Proposed Development boundary
 - Proposed Road Development
 - Proposed Culvert (C)
 - Proposed Attenuation Pond / Infiltration Basin
 - Proposed Stream Diversion
 - Drainage Network Sections
 - S00 Catchment Reference Section
 - Drainage Outfall

Son áiríamh tá sonraíocht Shairbhíreacht Orlándaí Éireann arna aistriú go dtí físeán OSI Uimh. 2010/18CCMA/Comhairle Contae na Gaillimhe. Sáráilom aistriú go dtí na h-áiríamh na h-Éireann. © Sairbhíreacht Orlándaí Éireann, 2010.

© Sairbhíreacht Orlándaí Éireann. Gach ceart ar chosaint. Uimhir cheadúnais 2010/18CCMA/Comhairle Contae na Gaillimhe.

Includes Ordnance Survey Ireland data reproduced under OSI Licence number 2010/18CCMA/Galway County Council. Unauthorised reproduction infringes Ordnance Survey Ireland and Government of Ireland copyright. © Ordnance Survey Ireland, 2010.

© Ordnance Survey Ireland. All rights reserved. Licence number 2010/18CCMA/Galway County Council.

Clients

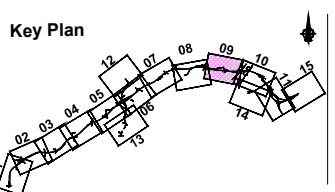

Consultant

Corporate House
City East Business Park
Ballybrit, Galway, Ireland.

Tel +353 (0)91 460675
www.N6GalwayCity.ie
www.arup.ie

Job Title
N6 Galway City Ring Road

Scale
1:5000 @ A3

Date:
September 2018

Issue	Date	By	Chkd	Appd
11	28/09/2018	KJ	MH	EMC

Drawing Title
Proposed Road Development Plan Layout and Drainage Network

Sheet 9 of 15

Drawing Status
For Information

Job No
233985

Drawing No
Figure 11.5.109

Issue
11

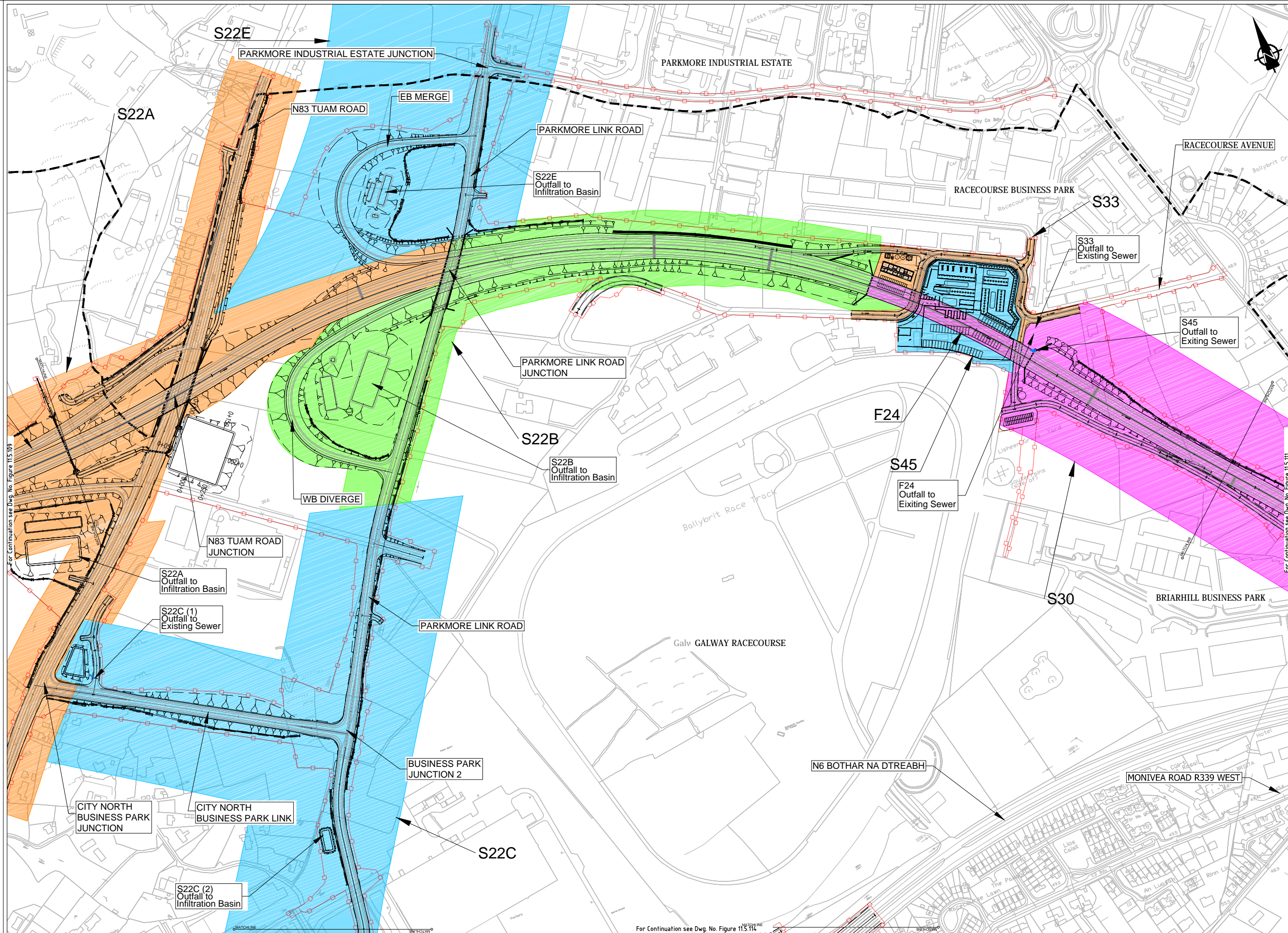

- Legend:**
- City Boundary
 - - - Proposed Development boundary
 - ▬▬▬ Proposed Road Development
 - Proposed Culvert (C)
 - ▭ Proposed Attenuation Pond / Infiltration Basin
 - ~ Proposed Stream Diversion
 - █ Drainage Network Sections
 - ↖ S00 Catchment Reference Section
 - ▭ Drainage Outfall

For Continuation see Dwg. No. Figure 11.5.109

For Continuation see Dwg. No. Figure 11.5.111

Sun áirímhá tá sonraíocht Shuirbhíreachtú Orlándaís Éireann arna aistriú go dtí fíor Cheadúnas OSI Uimh. 2010/18CCMA/Comhairle Contae na Gaillimhe. Sáráilom aistriú go dtí na h-áirímháí na císcheart Shuirbhíreachtú Orlándaís Éireann agus Rialtas na hÉireann. © Suirbhíreachtú Orlándaís Éireann, 2010.

© Suirbhíreachtú Orlándaís Éireann. Gach ceart ar chosaint. Uimhir cheadúnais 2010/18CCMA/Comhairle Contae na Gaillimhe.

Includes Ordnance Survey Ireland data reproduced under OSI Licence number 2010/18CCMA/Galway County Council. Unauthorised reproduction infringes Ordnance Survey Ireland and Government of Ireland copyright. © Ordnance Survey Ireland, 2010.

© Ordnance Survey Ireland. All rights reserved. Licence number 2010/18CCMA/Galway County Council.

Clients

Comhairle Chontae na Gaillimhe
Galway County Council

Galway City Transport Project

An Roinn Iompair
Turasóireachta agus Spóirt
Department of Transport, Tourism and Sport

TII
Transport Infrastructure Ireland

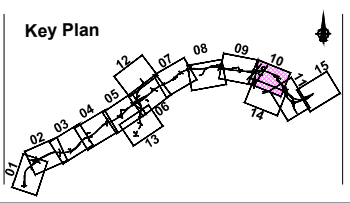

Consultant

ARUP

Corporate House
City East Business Park
Ballybrit, Galway, Ireland.

Tel +353 (0)91 460675
www.N6GalwayCity.ie
www.arup.ie

Job Title
N6 Galway City Ring Road

Scale
1:5000 @ A3

Date:
September 2018

Issue	Date	By	Chkd	Appd
11	28/09/2018	KJ	MH	EMC

Drawing Title
Proposed Road Development Plan Layout

Sheet 10 of 15

For Information

Job No: **233985**
Drawing No: **Figure 11.5.110**
Issue: **11**

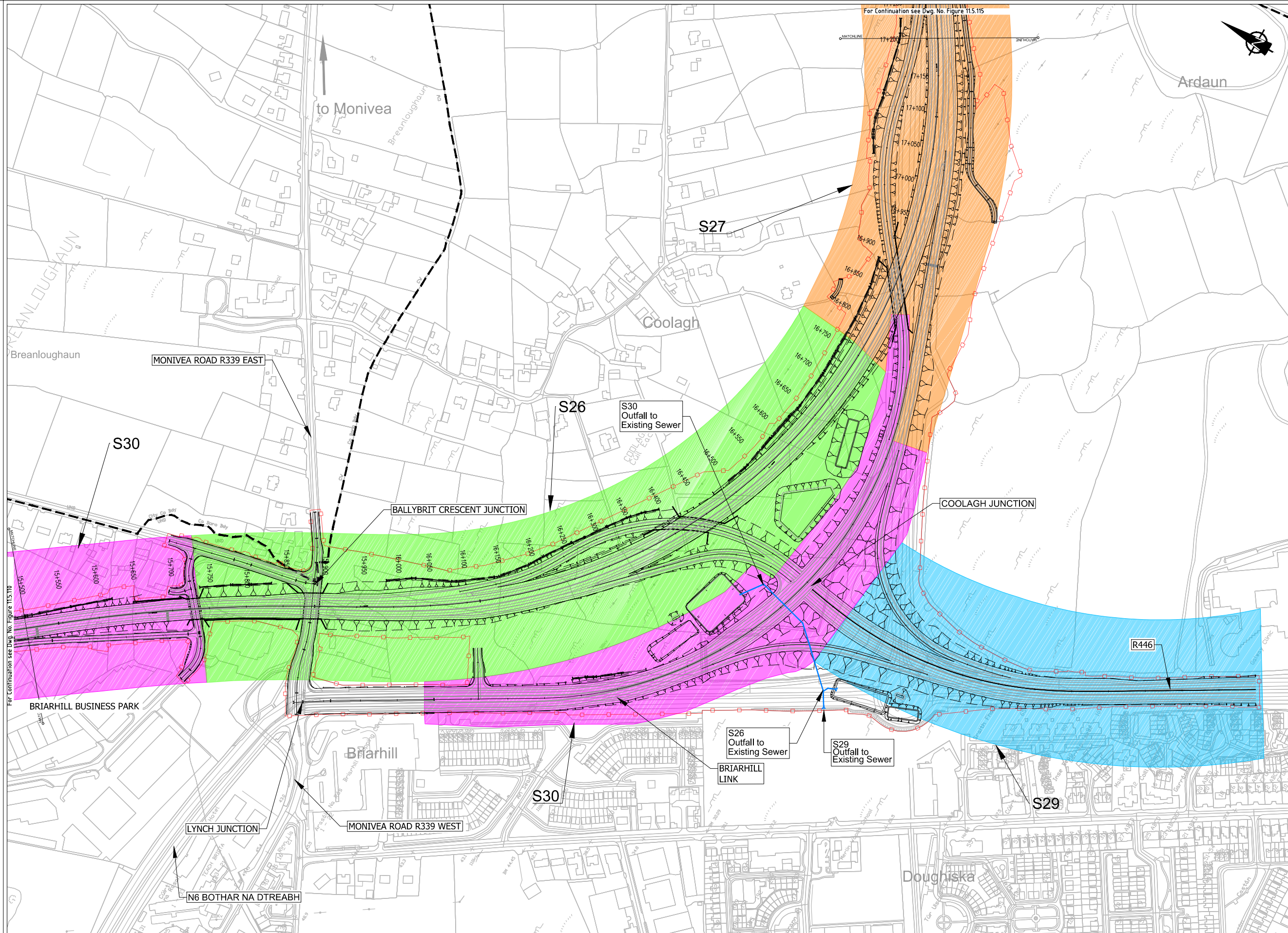

- Legend:**
- City Boundary
 - Proposed Development boundary
 - ▨ Proposed Road Development
 - Proposed Culvert (C)
 - ▭ Proposed Attenuation Pond / Infiltration Basin
 - Proposed Stream Diversion
 - █ Drainage Network Sections
 - S00 Catchment Reference Section
 - Drainage Outfall

For Continuation see Dwg. No. Figure 11.5.110

For Continuation see Dwg. No. Figure 11.5.115

Son áiríomh tá sonraíocht Shairbhíreacha Orlandáis Éireann arna aistriú go dtí físeán Chaidéas OSI Uimh. 2010/18CCMA/Comhairle Contae na Gaillimhe. Sáráilom aistriú go dtí na h-áiríomh na h-Éireann agus Rialtas na hÉireann. © Sairbhíreacha Orlandáis Éireann, 2010.

© Sairbhíreacha Orlandáis Éireann. Gach ceart ar chosaint. Uimhir cheadainis 2010/18CCMA/Comhairle Contae na Gaillimhe.

Includes Ordnance Survey Ireland data reproduced under OSI Licence number 2010/18CCMA/Galway County Council. Unauthorised reproduction infringes Ordnance Survey Ireland and Government of Ireland copyright. © Ordnance Survey Ireland, 2010.

© Ordnance Survey Ireland. All rights reserved. Licence number 2010/18CCMA/Galway County Council.

Clients

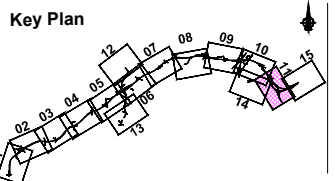

Consultant

Corporate House
City East Business Park
Ballybrit, Galway, Ireland.

Tel +353 (0)91 460675
www.NGalwayCity.ie
www.arup.ie

Job Title
N6 Galway City Ring Road

Scale
1:5000 @ A3

Date:
September 2018

11	28/09/2018	KJ	MH	EMC
Issue	Date	By	Chkd	Appd

Drawing Title
Proposed Road Development Plan Layout and Drainage Network
Sheet 11 of 15

Drawing Status
For Information

Job No
233985

Drawing No
Figure 11.5.111

Issue
11

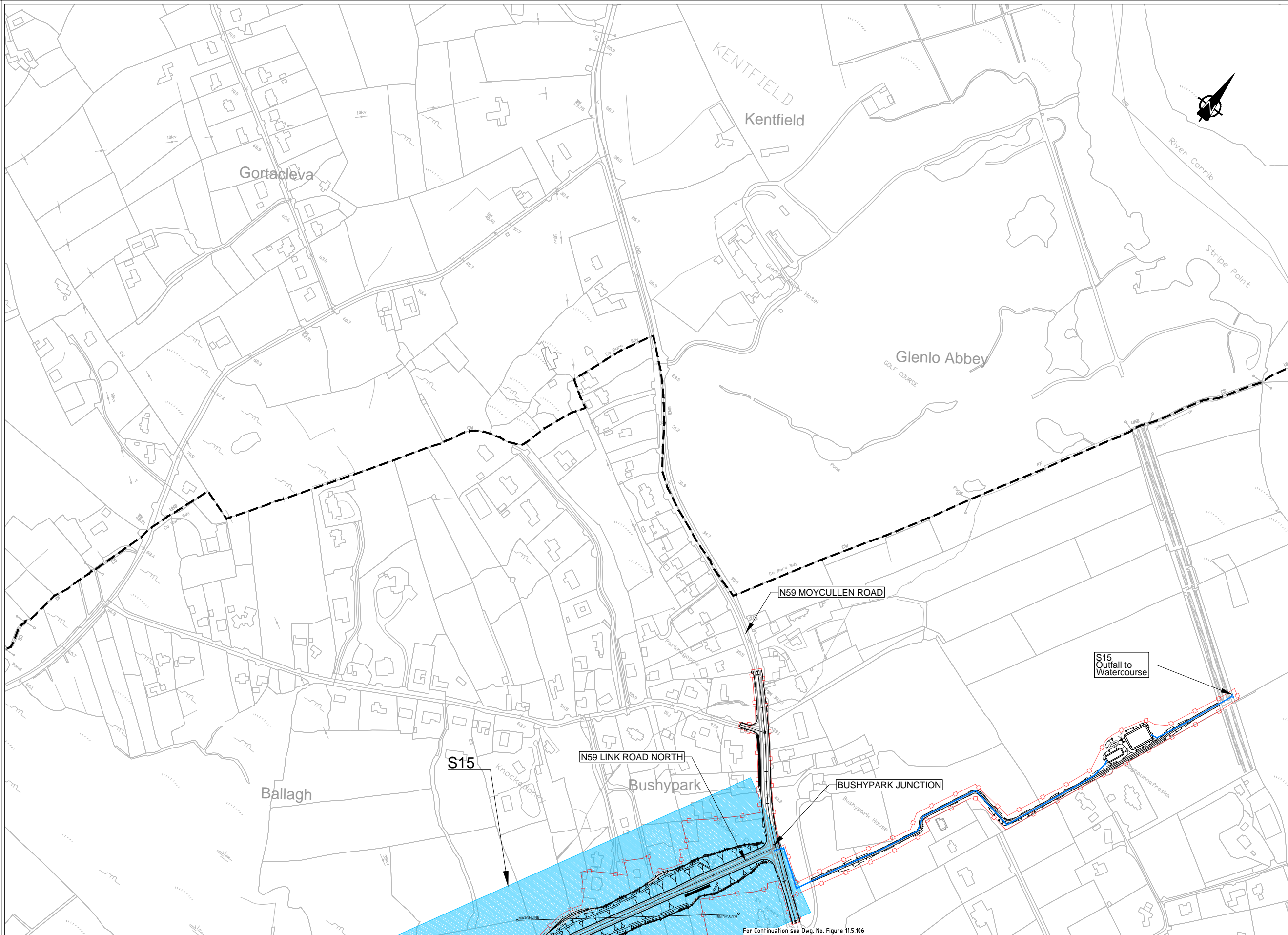

- Legend:**
- City Boundary
 - Proposed Development boundary
 - Proposed Road Development
 - Proposed Culvert (C)
 - Proposed Attenuation Pond / Infiltration Basin
 - Proposed Stream Diversion
 - Drainage Network Sections
 - S00 Catchment Reference Section
 - Drainage Outfall

Son áiríamh tá sonraíocht Shuirbhíreachtú Ordoánais Éireann arna aistriú go dtí físeán OSI Uimh. 2010/18CCMA/Comhairle Contae na Gaillimhe. Sáráilom aistriú go dtí neamhdáraithe cóipeacht Shuirbhíreachtú Ordoánais Éireann agus Rialtas na hÉireann. © Suirbhíreachtú Ordoánais Éireann, 2010.

© Suirbhíreachtú Ordoánais Éireann. Gach ceart ar chosaint. Uimhir cheadúnais 2010/18CCMA/Comhairle Contae na Gaillimhe.

Includes Ordnance Survey Ireland data reproduced under OSI Licence number 2010/18CCMA/Galway County Council. Unauthorised reproduction infringes Ordnance Survey Ireland and Government of Ireland copyright. © Ordnance Survey Ireland, 2010.

© Ordnance Survey Ireland. All rights reserved. Licence number 2010/18CCMA/Galway County Council.

Clients

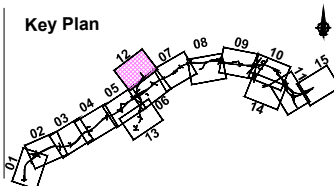

Consultant

Corporate House
City East Business Park
Ballybrit, Galway, Ireland.

Tel +353 (0)91 460675
www.N6GalwayCity.ie
www.arup.ie

Job Title
N6 Galway City Ring Road

Scale
1:5000 @ A3

Date:
September 2018

Issue	Date	By	Chkd	Appd
11	28/09/2018	KJ	MH	EMC

Drawing Title
Proposed Road Development Plan Layout and Drainage Network

Sheet 12 of 15

Drawing Status
For Information

Job No 233985	Drawing No Figure 11.5.112	Issue 11
-------------------------	--------------------------------------	--------------------

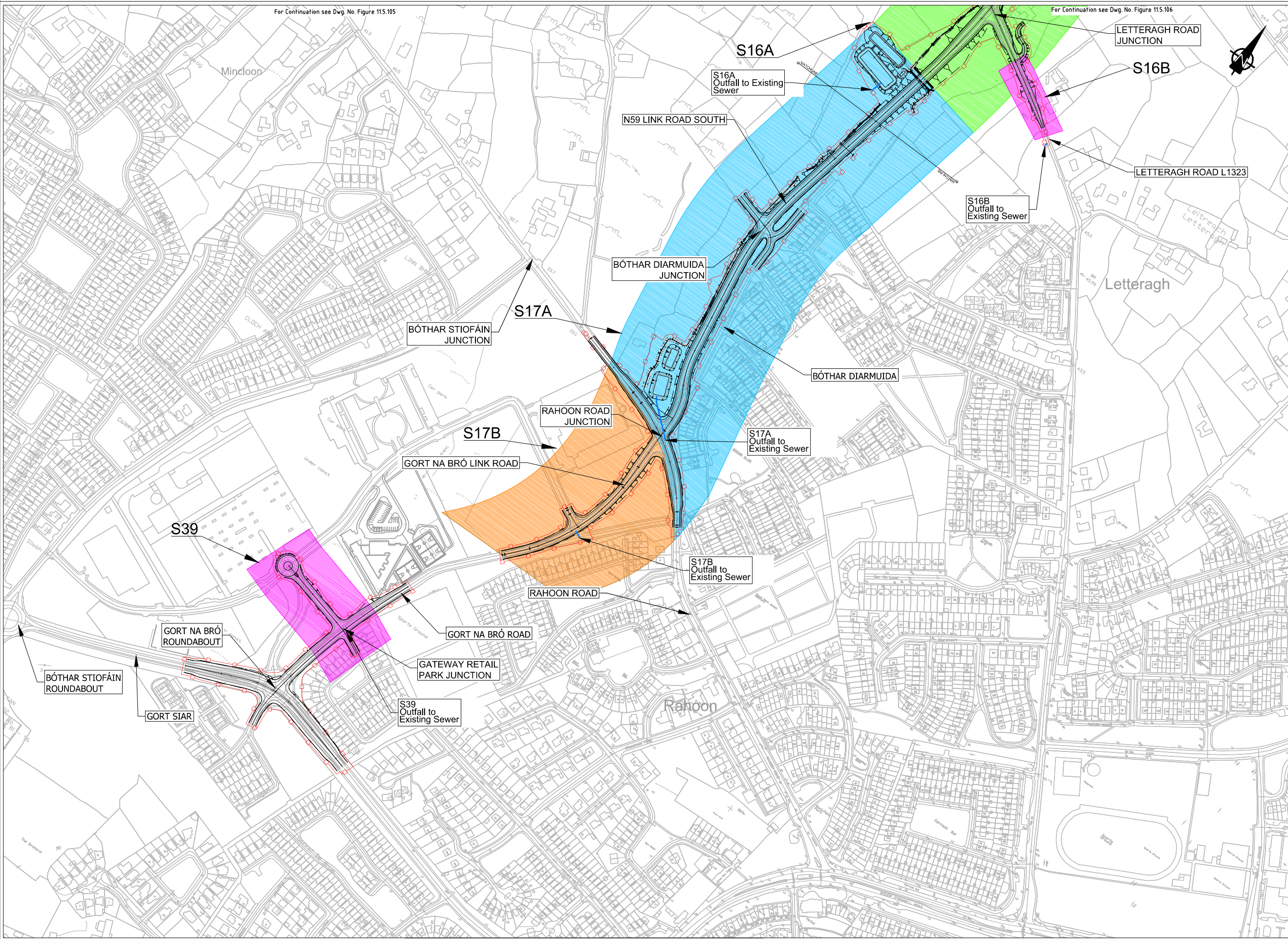

- Legend:**
- City Boundary
 - Proposed Development boundary
 - Proposed Road Development
 - Proposed Culvert (C)
 - Proposed Attenuation Pond / Infiltration Basin
 - Proposed Stream Diversion
 - Drainage Network Sections
 - S00 Catchment Reference Section
 - Drainage Outfall

Son áireamh tá sonraíocht Shairbhéireacht Orlánáis Éireann arna aistriú go dtí físeán Ceidhúnas OSI Uimh. 2010/18CCMA/Comhairle Contae na Gaillimhe. Sáráilonn aistriú go dtí neamhádaraithe cóipeacht Shairbhéireacht Orlánáis Éireann agus Rialtas na hÉireann. © Sairbhéireacht Orlánáis Éireann, 2010.

Includes Ordnance Survey Ireland data reproduced under OSI Licence number 2010/18CCMA/Galway County Council. Unauthorised reproduction infringes Ordnance Survey Ireland and Government of Ireland copyright. © Ordnance Survey Ireland, 2010.

© Ordnance Survey Ireland. All rights reserved. Licence number 2010/18CCMA/Galway County Council.

Clients

Comhairle Contae na Gaillimhe
Galway County Council

Galway City Transport Project

An Roinn Iompair
Turasóireachta agus Spóirt

TIIP
Bonneagar Transport Éireann

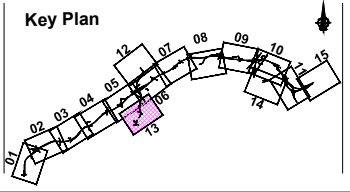

Consultant

ARUP

Corporate House
City East Business Park
Ballybrit, Galway, Ireland.

Tel +353 (0)91 460675
www.N6GalwayCity.ie
www.arup.ie

Job Title
N6 Galway City Ring Road

Scale
1:5000 @ A3

Date:
September 2018

Issue	Date	By	Chkd	Appd
11	28/09/2018	KJ	MH	EMC

Drawing Title
Proposed Road Development Plan Layout
and Drainage Network
Sheet 13 of 15

Drawing Status
For Information

Job No
233985

Drawing No
Figure 115.113

Issue
11

For Continuation see Dwg. No. Figure 11.5.110

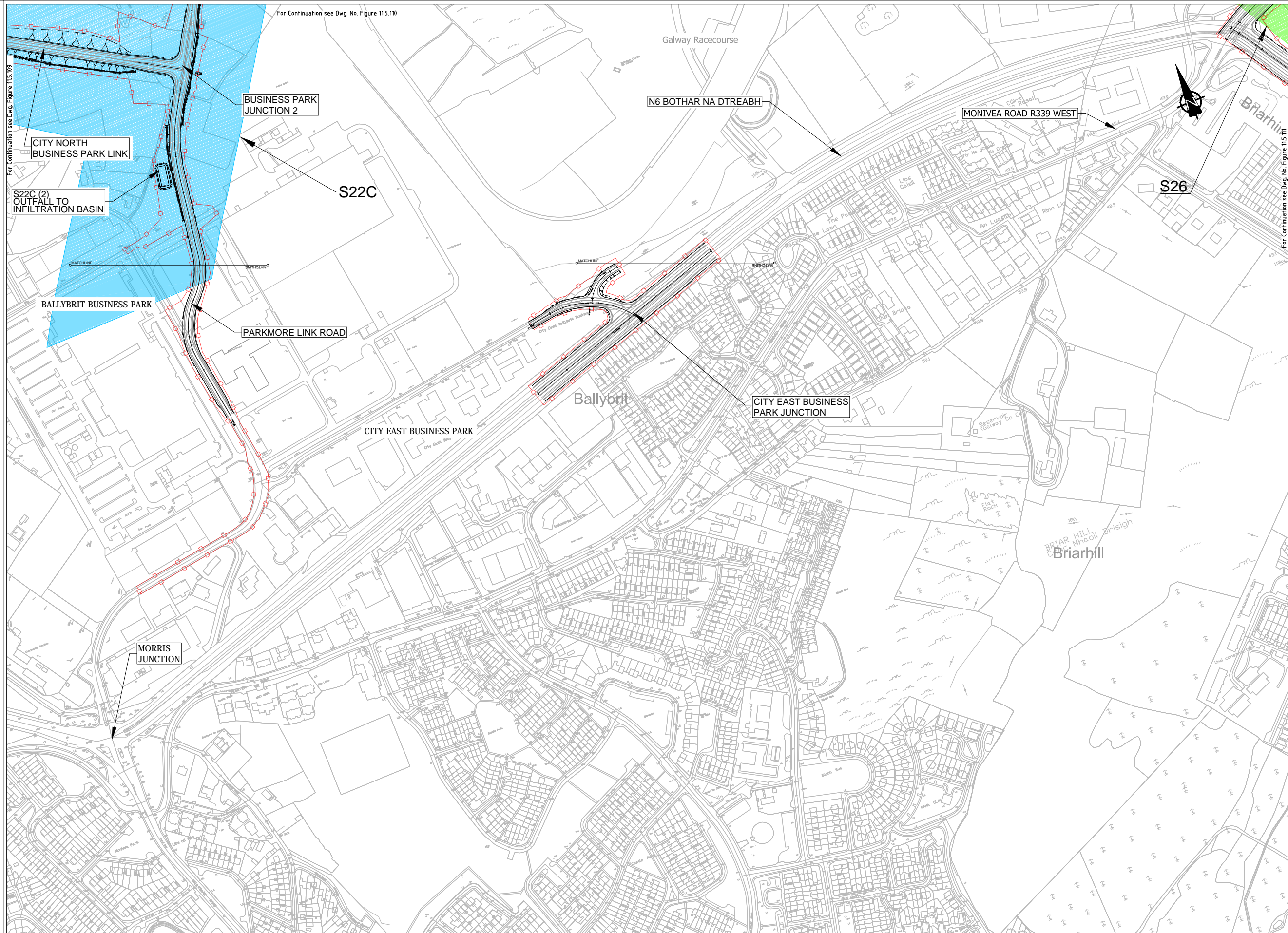

- Legend:**
- City Boundary
 - Proposed Development boundary
 - Proposed Road Development
 - Proposed Culvert (C)
 - Proposed Attenuation Pond / Infiltration Basin
 - Proposed Stream Diversion
 - Drainage Network Sections
 - S00 Catchment Reference Section
 - Drainage Outfall

Son áiríamh tá sonraíocht Shuirbhíreacht Orlándaís Éireann arna aistriú go dtí físeán OSI Uimh. 2010/18CCMA/Comhairle Contae na Gaillimhe. Sáráilom aistriú go dtí neamháidaráithe cóipeacht Shuirbhíreacht Orlándaís Éireann agus Rialtas na hÉireann. © Suirbhíreacht Orlándaís Éireann, 2010.

© Suirbhíreacht Orlándaís Éireann. Gach ceart ar chosaint. Uimhir cheadainis 2010/18CCMA/Comhairle Contae na Gaillimhe.

Includes Ordnance Survey Ireland data reproduced under OSI Licence number 2010/18CCMA/Galway County Council. Unauthorised reproduction infringes Ordnance Survey Ireland and Government of Ireland copyright. © Ordnance Survey Ireland, 2010.

© Ordnance Survey Ireland. All rights reserved. Licence number 2010/18CCMA/Galway County Council.

Clients

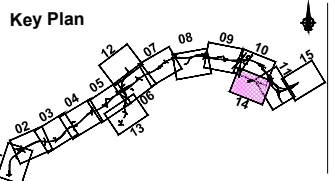

Consultant

Corporate House
City East Business Park
Ballybrit, Galway, Ireland.

Tel +353 (0)91 460675
www.NGalwayCity.ie
www.arup.ie

Job Title
N6 Galway City Ring Road

Scale
1:5000 @ A3

Date:
September 2018

11	28/09/2018	KJ	MH	EMC
Issue	Date	By	Chkd	Appd

Drawing Title
Proposed Road Development Plan Layout and Drainage Network

Sheet 14 of 15

Drawing Status
For Information

Job No 233985	Drawing No Figure 11.5.114	Issue 11
-------------------------	--------------------------------------	--------------------

- Legend:**
- City Boundary
 - Proposed Development boundary
 - Proposed Road Development
 - Proposed Culvert (C)
 - Proposed Attenuation Pond / Infiltration Basin
 - Proposed Stream Diversion
 - Drainage Network Sections
 - S00 Catchment Reference Section
 - Drainage Outfall

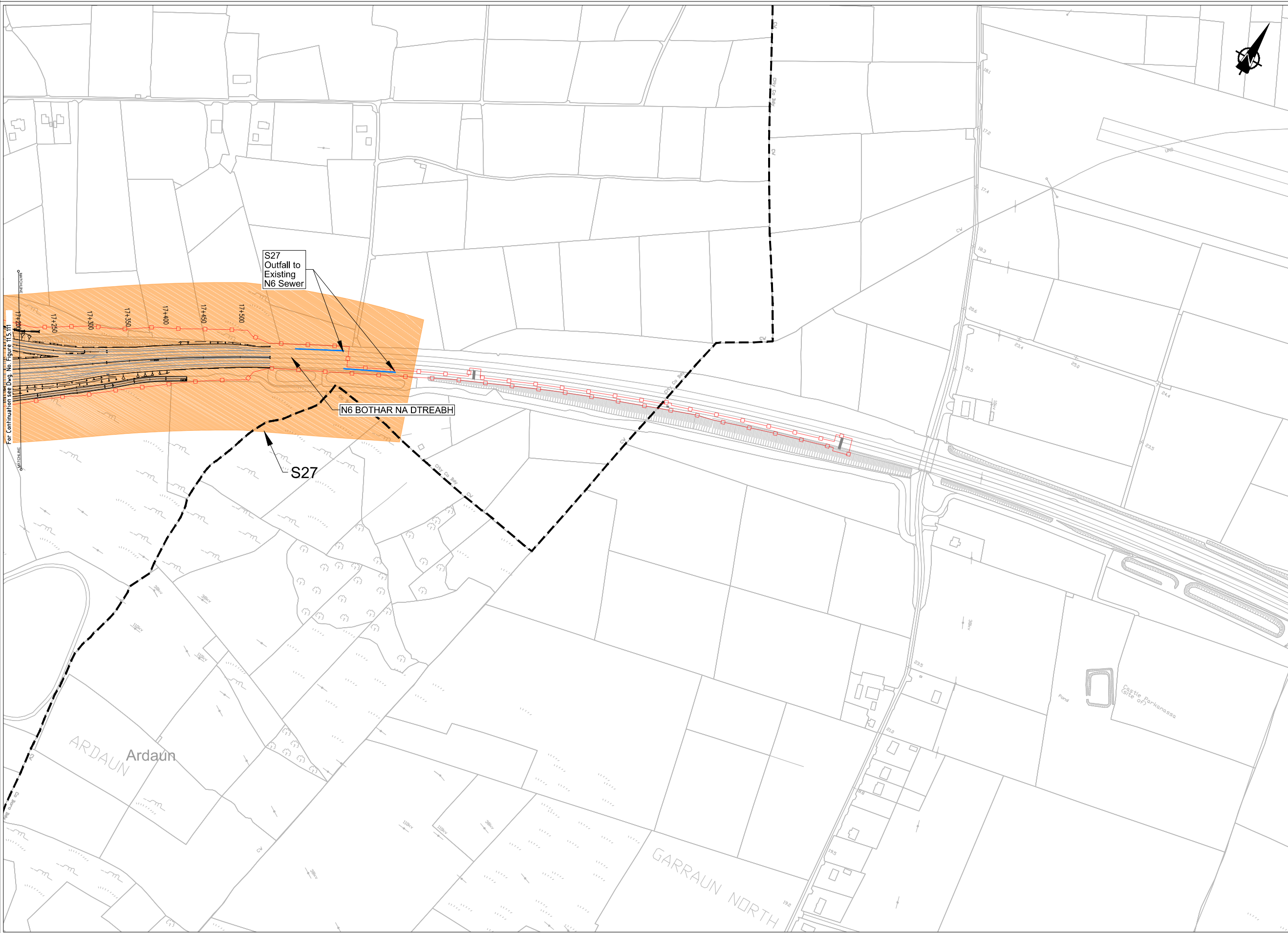

San áirneamh tá sonraíocht Shuirbhíreacht Orlándaís Éireann arna aistriú go dtailíú físe Chéadánas OSI Uimh. 2010/18CCMA/Comhairle Contae na Gaillimhe. Sáráilom aistriú go dtailíú neamhdáraithe cóipeacht Shuirbhíreacht Orlándaís Éireann agus Rialtas na hÉireann. © Suirbhíreacht Orlándaís Éireann, 2010.

© Suirbhíreacht Orlándaís Éireann. Gach ceart ar chosaint. Uimhir cheadnáis 2010/18CCMA/Comhairle Contae na Gaillimhe.

Includes Ordnance Survey Ireland data reproduced under OSI Licence number 2010/18CCMA/Galway County Council. Unauthorised reproduction infringes Ordnance Survey Ireland and Government of Ireland copyright. © Ordnance Survey Ireland, 2010.

© Ordnance Survey Ireland. All rights reserved. Licence number 2010/18CCMA/Galway County Council.

Clients

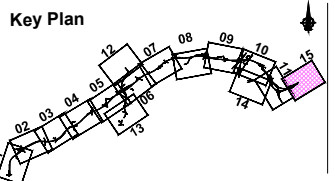

Consultant

Corporate House
City East Business Park
Ballybrit, Galway, Ireland.

Tel +353 (0)91 460675
www.N6GalwayCity.ie
www.arup.ie

Job Title
N6 Galway City Ring Road

Scale
1:5000 @ A3

Date:
September 2018

Issue	Date	By	Chkd	Appd
11	28/09/2018	KJ	MH	EMC

Drawing Title
Proposed Road Development Plan Layout and Drainage Network References References

Sheet 15 of 15

Drawing Status
For Information

Job No 233985	Drawing No Figure 11.5.115	Issue 11
-------------------------	--------------------------------------	--------------------